

**ELEKTRO** ➔  
**AUTOMATIC**

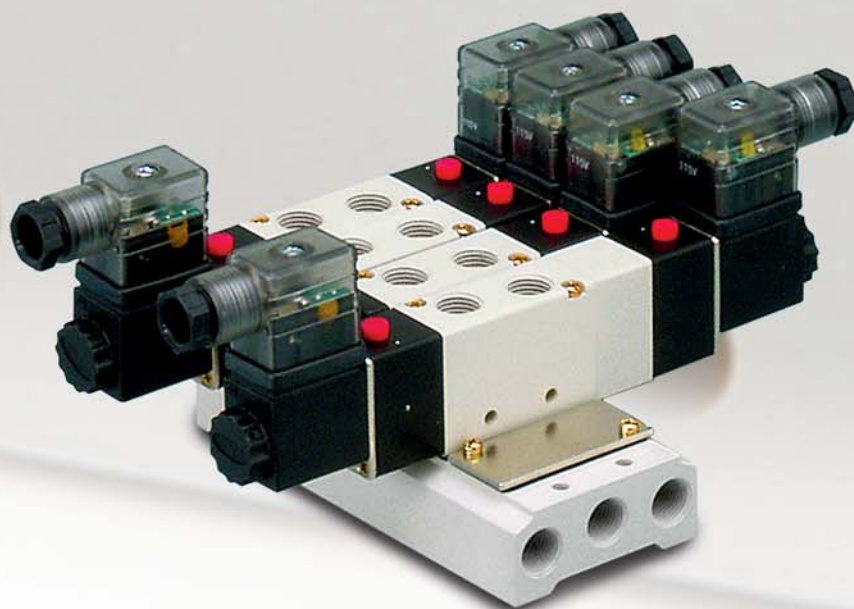

05-820 **PIASTÓW** k/ W-wy  
ul. Elizy Orzeszkowej 64  
tel./fax ( 022) **723-15-43** tel. (022) 753-94-79  
tel.GSM 0-693-666-555

e-mail: [biuro@elektro-automatic.com.pl](mailto:biuro@elektro-automatic.com.pl) <http://www.elektro-automatic.com.pl>

## **ELETTROVALVOLE PNEUMATICHE**

## **SOLENOID VALVES**

**ELEKTROZAWORY I ZAWORY STEROWANE PNEUMATYCZNIE**

**farbo**  
PNEUMATIC

**KOD**

**VE  
VA  
3/2**

**VE  
VA  
5/2**

**VE  
VA  
5/3**

**VN  
5/2**

**VP  
3/2**

**VP  
5/2**

**VP  
5/3**

Droga	Opis	VE	Symbol VA	VP	VN
<b>N</b>	3/2 MONOSTABILNY, NORMALNIE ZAMKNIĘTY - NC, POWRÓT SPRĘŻYNA				
<b>O</b>	3/2 MONOSTABILNY, NORMALNIE OTWARTY - NO, POWRÓT SPRĘŻYNA				
<b>T</b>	3/2 BISTABILNY				
<b>M</b>	5/2 MONOSTABILNY, POWRÓT SPRĘŻYNA				
<b>S</b>	5/2 BISTABILNY				
<b>C</b>	5/3 CENTRALNE POŁOŻENIE ZAMKNIĘTE				
<b>A</b>	5/3 CENTRALNE POŁOŻENIE OTWARTE				
<b>D</b>	5/3 W CENTRALNYM POŁOŻENIU ZASILANY				

ELEKTROZAWÓR	
<b>VE</b>	Zawór z gniazdami gwintowanymi
<b>VN</b>	NAMUR
<b>VA</b>	Zawór ze sterowaniem zewnętrznym
<b>VP</b>	Zawór pneumatyczny

ROZMIAR	
<b>S</b>	maly 18 mm.
<b>M</b>	sredni 22 mm
<b>L</b>	duzy 27 mm
<b>X</b>	wielki 34 mm

GWINT-Przylacza	
<b>8</b>	G 1/8"
<b>4</b>	G 1/4"
<b>3</b>	G 3/8"
<b>2</b>	G 1/2"

**VE S 8 M . D2 C**

CEWKA	
<b>00</b>	Bez cewki i wtyczki
<b>A1</b>	AC 12 Volt - 2,5 W - 50/60 Hz
<b>A2</b>	AC 24 Volt - 2,5 W - 50/60 Hz
<b>A6</b>	AC 110 Volt - 2,5 W - 50/60 Hz
<b>A7</b>	AC 220 Volt - 2,5 W - 50/60 Hz
<b>D1</b>	DC 12 Volt - 2,5 W
<b>D2</b>	DC 24 Volt - 2,5 W

WTYCZKA	
<b>0</b>	Bez wtyczki
<b>C</b>	Standard
<b>Z Ledem i zabezpieczeniem</b>	
<b>Y</b>	Zółty LED
<b>R</b>	Czerwony LED
<b>G</b>	Zielony LED

VE - VA - VP - VN*														
Rozmiar	mm	Gwint	Kod				N	O	T	M	S	C	A	D
<b>S</b>	<b>18</b>	G 1/8"	<b>VES8</b>	<b>VAS8</b>	<b>VPS8</b>									
<b>M</b>	<b>22</b>	G 1/8"	<b>VEM8</b>	<b>VAM8</b>	<b>VPM8</b>	<b>VNM8</b>				(*)	(*)			
<b>M</b>	<b>22</b>	G 1/4"	<b>VEM4</b>	<b>VAM4</b>	<b>VPM4</b>	<b>VNM4</b>				(*)	(*)			
<b>L</b>	<b>27</b>	G 1/4"	<b>VEL4</b>	<b>VAL4</b>	<b>VPL4</b>	<b>VNL4</b>				(*)	(*)			
<b>L</b>	<b>27</b>	G 3/8"	<b>VEL3</b>	<b>VAL3</b>	<b>VPL3</b>	<b>VNL3</b>				(*)	(*)			
<b>X</b>	<b>34</b>	G 1/2"	<b>VEX2</b>	<b>VAX2</b>	<b>VPX2</b>									

**Kody dla zamówień cewek i wtyczek osobno**

**(\*) Specjalna wersja dostępna dla Serii VN**

S Rozmiar	M - L - X Rozmiar	CEWKI
17 mm	22 mm	
Kod		Moc
<b>BOB17.A1</b>	<b>BOB22.A1</b>	AC 12 Volt - 2,5 W
<b>BOB17.A2</b>	<b>BOB22.A2</b>	AC 24 Volt - 2,5 W
<b>BOB17.A6</b>	<b>BOB22.A6</b>	AC 110 Volt - 2,5 W
<b>BOB17.A7</b>	<b>BOB22.A7</b>	AC 220 Volt - 2,5 W
<b>BOB17.D1</b>	<b>BOB22.D1</b>	DC 12 Volt - 2,5 W
<b>BOB17.D2</b>	<b>BOB22.D2</b>	DC 24 Volt - 2,5 W

S Rozmiar	M - L - X Rozmiar	WTYCZKI	
17 mm	22 mm		
Kod		Opis	Moc Power
<b>CON17C</b>	<b>CON22C</b>	Standard	<b>12 - 230 Volt</b>
<b>CON17Y.24</b>	<b>CON22Y.24</b>	Zółty LED + zabezpieczenie	<b>12 - 24 Volt</b>
<b>CON17R.24</b>	<b>CON22R.24</b>	Czerwony LED + zabezp	<b>12 - 24 Volt</b>
<b>CON17G.24</b>	<b>CON22G.24</b>	Zielony LED + zabezp	<b>12 - 24 Volt</b>
<b>CON17Y.110</b>	<b>CON22Y.110</b>	Zółty LED + zabezp	<b>115 Volt</b>
<b>CON17R.110</b>	<b>CON22R.110</b>	Czerwony LED + zabezp	<b>115 Volt</b>
<b>CON17G.110</b>	<b>CON22G.110</b>	Zielony LED + zabezp	<b>115 Volt</b>
<b>CON17Y.220</b>	<b>CON22Y.220</b>	Zółty LED + zabezp	<b>230 Volt</b>
<b>CON17R.220</b>	<b>CON22R.220</b>	Czerwony LED + zabezp	<b>230 Volt</b>
<b>CON17G.220</b>	<b>CON22G.220</b>	Zielony LED + zabezp	<b>230 Volt</b>

KOD

VE  
VA  
3/2

VE  
VA  
5/2

VE  
VA  
5/3

VN  
5/2

VP  
3/2

VP  
5/2

VP  
5/3

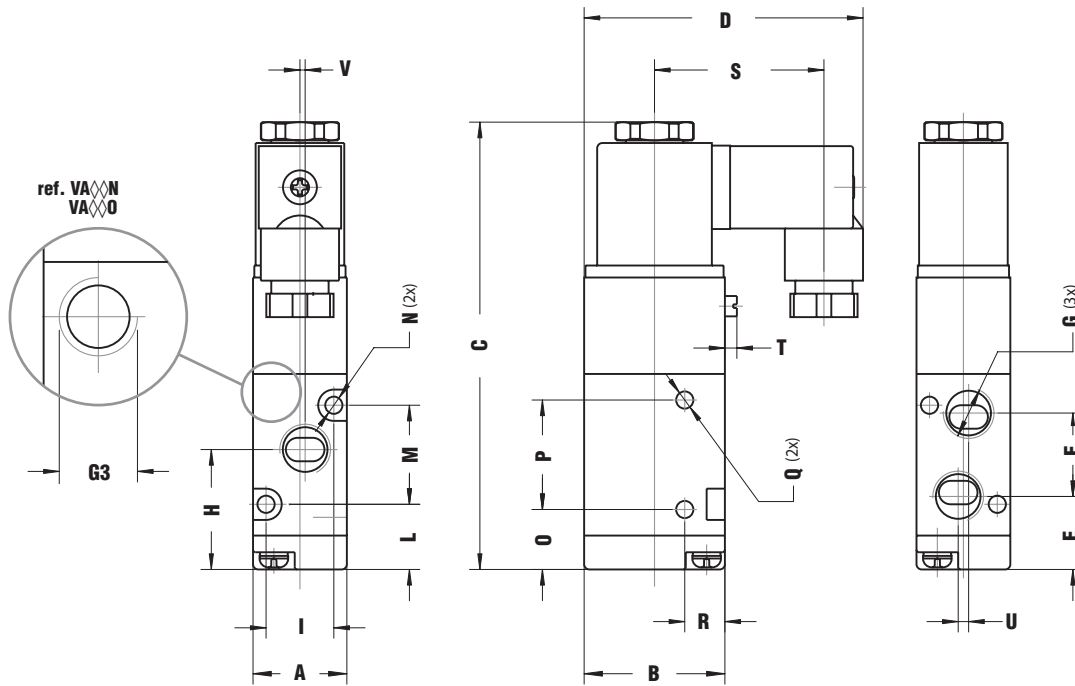
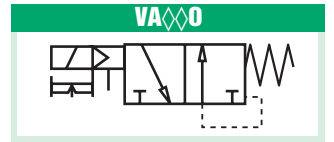
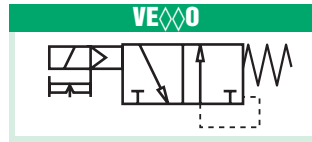
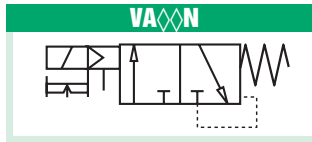
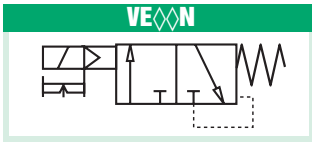

**Zawór ze sterowaniem zewnętrznym**

Kod		Przepływ (lt/min)	A	B	C	D	E	F	G	H	I	L	M	N	O	P	Q	R	S	T	U	V	Waga (g)	Kod		G3
<b>VES8N</b>	<b>VES8O</b>	<b>450</b>	18	27	85,8	53,5	14,0	16,0	G 1/8"	23,0	13	12,5	19	3,3	11,5	21	3,3	7,7	32,5	2,5	2	1	140	<b>VAS8N</b>	<b>VAS8O</b>	M5
<b>VEM8N</b>	<b>VEM8O</b>	<b>750</b>	22	35	108,4	66,5	16,3	22,5	G 1/8"	29,0	17	12,5	30	3,2	15,0	25	4,3	8,0	40,0	3,0	-	-	200	<b>VAM8N</b>	<b>VAM8O</b>	M5
<b>VEM4N</b>	<b>VEM4O</b>	<b>750</b>	22	35	108,4	66,5	16,3	22,5	G 1/4"	27,5	17	12,5	30	3,2	15,0	25	4,3	8,0	40,0	3,0	-	-	200	<b>VAM4N</b>	<b>VAM4O</b>	M5
<b>VEL4N</b>	<b>VEL4O</b>	<b>1100</b>	27	40	119,4	69,0	20,5	24,0	G 1/4"	32,5	20	15,0	35	4,3	17,5	30	4,3	10,5	40,0	3,0	-	-	270	<b>VAL4N</b>	<b>VAL4O</b>	M5
<b>VEL3N</b>	<b>VEL3O</b>	<b>1100</b>	27	40	119,4	69,0	20,5	24,0	G 3/8"	32,5	20	15,0	35	4,3	17,5	30	4,3	10,5	40,0	3,0	-	-	325	<b>VAL3N</b>	<b>VAL3O</b>	M5

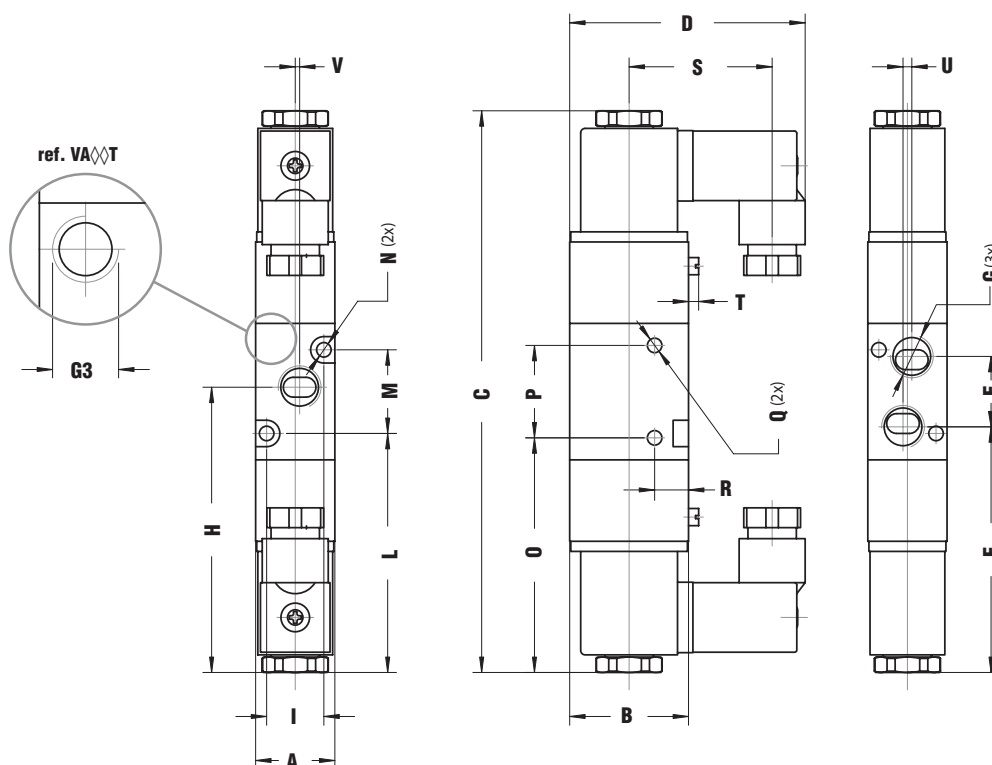
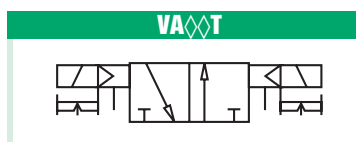
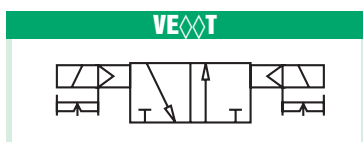

Zawór ze sterowaniem zewnętrznym

Kod	Przepływ (lt/min)	A	B	C	D	E	F	G	H	I	L	M	N	O	P	Q	R	S	T	U	V	Waga (g)	Zawór ze sterowaniem zewnętrznym	
																							Kod	G3
VES8T	450	18	27	127,6	53,5	55,8	16,0	G 1/8"	64,8	13	54,3	19	3,3	53,3	21	3,3	7,7	32,5	2,5	2	1	220	VAS8T	M5
VEM8T	750	22	35	162,0	66,5	70,0	22,5	G 1/8"	81,0	17	66,0	30	3,2	68,4	25	4,3	8	40,0	3,0	-	-	290	VAM8T	M5
VEM4T	750	22	35	162,0	66,5	70,0	22,5	G 1/4"	81,0	17	66,0	30	3,2	68,4	25	4,3	8	40,0	3,0	-	-	280	VAM4T	M5
VEL4T	1100	27	40	174,0	69,0	75,0	24,0	G 1/4"	87,0	20	69,4	35	4,3	72,0	30	4,3	10,5	40,0	3,0	-	-	355	VAL4T	M5
VEL3T	1100	27	40	174,0	69,0	75,0	24,0	G 3/8"	69,4	20	87,0	35	4,3	72,0	30	4,3	10,5	40,0	3,0	-	-	355	VAL3T	M5



KOD

VE  
VA  
3/2

VE  
VA  
5/2

VE  
VA  
5/3

VN  
5/2

VP  
3/2

VP  
5/2

VP  
5/3

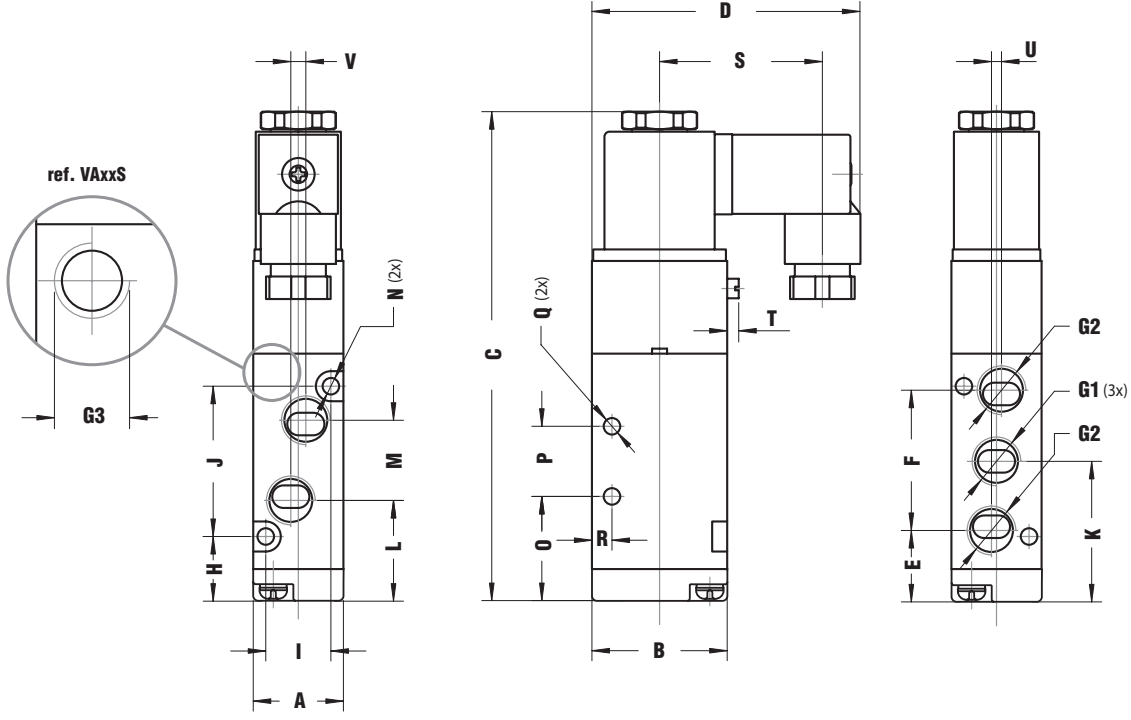
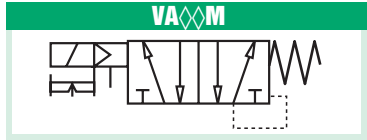
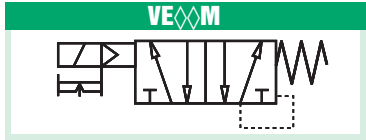

Zawór ze sterowaniem zewnętrznym

Kod	Przepływ (lt/min)	A	B	C	D	E	F	G1	G2	H	I	J	K	L	M	N	O	P	Q	R	S	T	U	V	Waga (g)	Kod	G3
VES8M	500	18	27	98,0	53,5	14,0	28	G 1/8"	G 1/8"	13,0	13	30	28,0	20,0	16	3,3	21,0	14	3,3	4	32,5	2,5	2	3	120	VAS8M	M5
VEM8M	600	22	35	116,5	66,5	13,5	36	G 1/8"	G 1/8"	12,5	17	38	31,5	22,5	18	3,2	21,5	20	4,3	7	40,0	3,0	-	-	220	VAM8M	M5
VEM4M	750	22	35	116,5	66,5	13,5	36	G 1/4"	G 1/8"	12,5	17	38	31,5	21,0	21	3,2	21,5	20	4,3	7	40,0	3,0	-	-	220	VAM4M	M5
VEL4M	900	27	40	134,5	69,0	17,5	45	G 1/4"	G 1/4"	15,0	20	50	40,0	29,0	22	4,3	28,0	24	4,3	6,5	40,0	3,0	-	-	310	VAL4M	M5
VEL3M	1100	27	40	134,5	69,0	17,5	45	G 3/8"	G 1/4"	15,0	20	50	40,0	28,0	24	4,3	28,0	24	4,3	6,5	40,0	3,0	-	-	310	VAL3M	M5
VEX2M	2250	34	50	167,9	73,9	25,5	63	G 1/2"	G 1/2"	21,0	27	72	57,0	39,0	36	4,3	43,0	28	5,5	7,5	-	3,0	-	4	590	VAX2M	M5

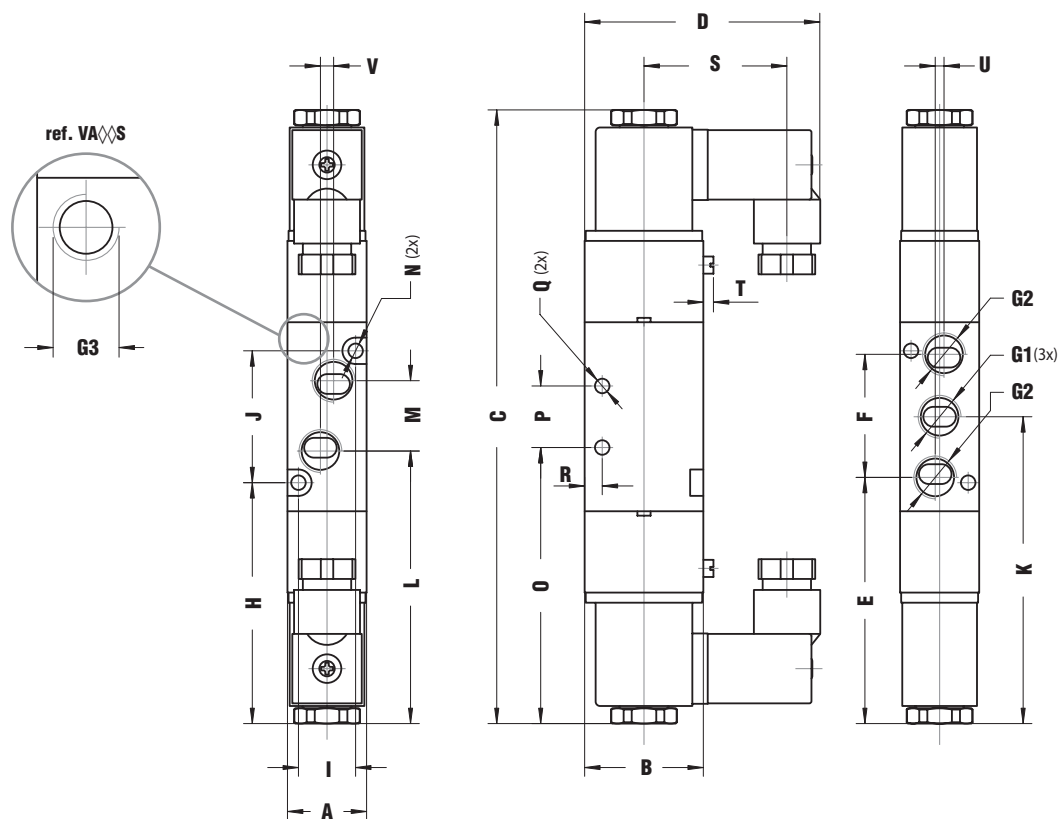
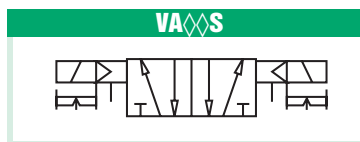

Zawór ze sterowaniem zewnętrznym

Kod	Przepływ (lt/min)	A B C D E F G1 G2 H I J K L M N O P Q R S T U V																			Waga (g)	Kod					
		G3																		G3							
<b>VES8S</b>	<b>500</b>	18	27	139,6	53,5	56,0	28	G 1/8"	G 1/8"	54,8	13	30	69,8	62,0	16	3,3	62,8	14	3,3	4,0	32,5	2,5	2	3	175	<b>VAS8S</b>	M5
<b>VEM8S</b>	<b>600</b>	22	35	169,8	66,5	66,9	36	G 1/8"	G 1/8"	65,9	17	38	84,9	75,9	18	3,2	74,9	20	4,3	7,0	40,0	3,0	-	-	320	<b>VAM8S</b>	M5
<b>VEM4S</b>	<b>750</b>	22	35	169,8	66,5	66,8	36	G 1/4"	G 1/8"	65,8	17	38	84,8	74,3	21	3,2	74,8	20	4,3	7,0	40,0	3,0	-	3	320	<b>VAM4S</b>	M5
<b>VEL4S</b>	<b>900</b>	-	-	188,8	69,0	71,9	45	G 1/4"	G 1/4"	69,4	-	50	94,4	83,4	22	4,3	82,4	24	4,3	6,5	40,0	3,0	-	-	400	<b>VAL4S</b>	M5
<b>VEL3S</b>	<b>1100</b>	27	40	188,8	69,0	71,9	45	G 3/8"	G 1/4"	69,4	20	50	94,4	82,4	24	4,3	82,4	24	4,3	6,5	40,0	3,0	-	-	400	<b>VAL3S</b>	M5
<b>VEX2S</b>	<b>2250</b>	34	50	221,8	73,9	79,4	63	G 1/2"	G 1/2"	74,9	27	72	110,9	92,9	36	4,3	96,9	28	5,5	7,5	-	3,0	-	4	770	<b>VAX2S</b>	M5

KOD

VE  
VA  
3/2

VE  
VA  
5/2

VE  
VA  
5/3

VN  
5/2

VP  
3/2

VP  
5/2

VP  
5/3

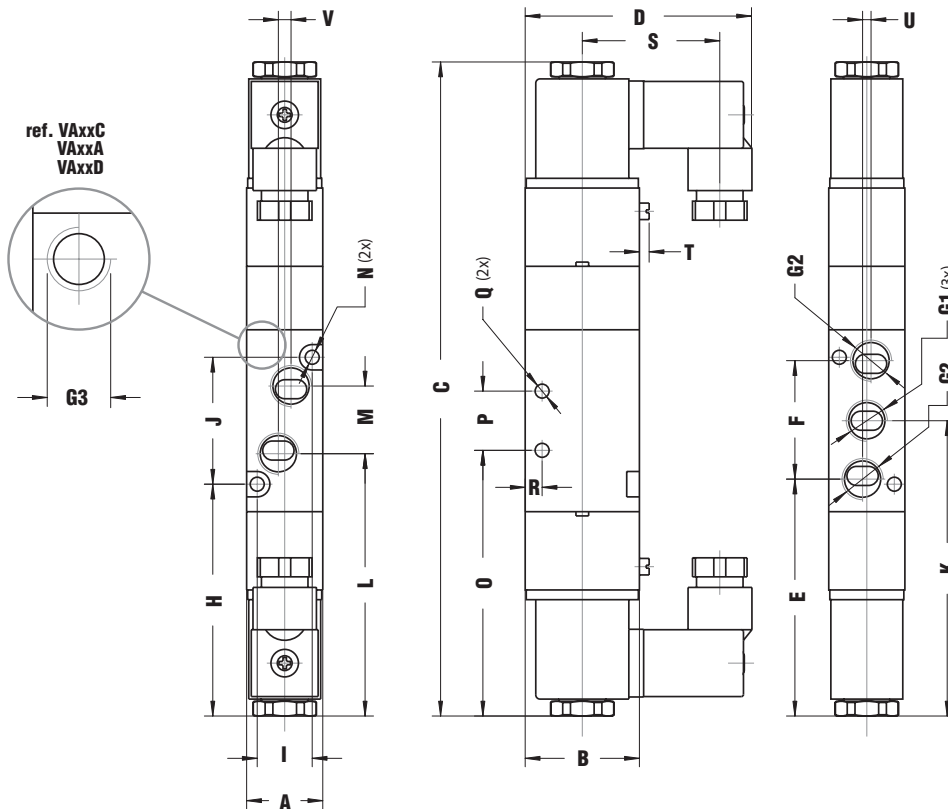
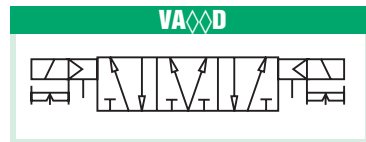
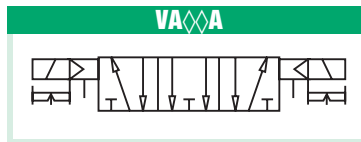
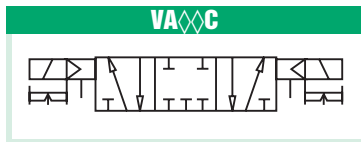
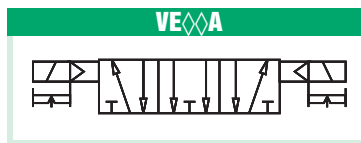
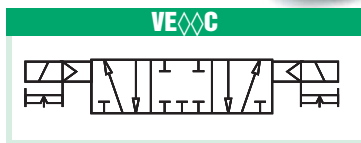
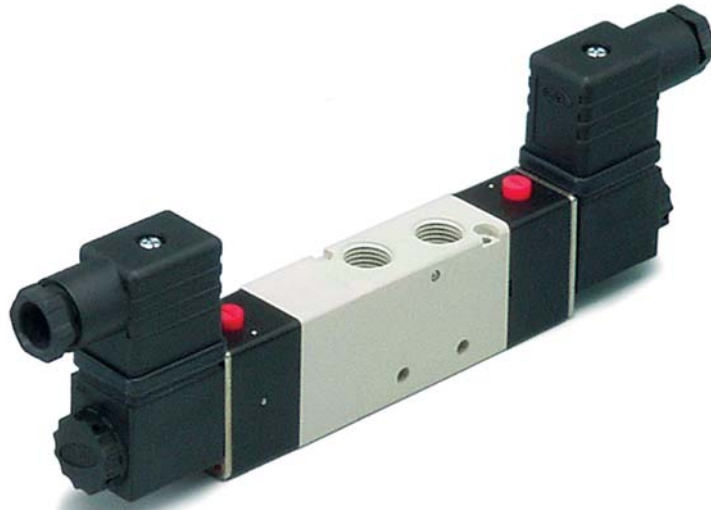

**Zawór ze sterowaniem zewnętrznym**

Kod			Przepływ (lt/min)	A	B	C	D	E	F	G1	G2	H	I	J	K	L	M	N	O	P	Q	R	S	T	U	V	Waga (g)	Kod			G3
VES8C	VES8A	VES8D	500	18	27	154,6	53,5	56,0	28	G 1/8"	G 1/8"	54,8	13	30	69,8	62,0	16	3,3	62,8	14	3,3	4,0	32,5	2,5	2	3	200	VAS8C	VAS8A	VAS8D	M5
VEM8C	VEM8A	VEM8D	600	22	35	188,8	66,5	66,9	36	G 1/8"	G 1/8"	65,9	17	38	84,9	75,9	18	3,2	74,9	20	4,3	7,0	40,0	3,0	-	-	400	VAM8C	VAM8A	VAM8D	M5
VEM4C	VEM4A	VEM4D	750	22	35	188,8	66,5	66,8	36	G 1/4"	G 1/8"	65,8	17	38	84,8	74,3	21	3,2	94,8	20	4,3	7,0	40,0	3,0	-	3	400	VAM4C	VAM4A	VAM4D	M5
VEL4C	VEL4A	VEL4D	900	-	-	207,8	69,0	71,9	45	G 1/4"	G 1/4"	69,4	-	50	94,4	83,4	22	4,3	82,4	24	4,3	6,5	40,0	3,0	-	-	540	VAL4C	VAL4A	VAL4D	M5
VEL3C	VEL3A	VEL3D	1100	27	40	207,8	69,0	71,9	45	G 3/8"	G 1/4"	69,4	20	50	94,4	82,4	24	4,3	82,4	24	4,3	6,5	40,0	3,0	-	-	540	VAL3C	VAL3A	VAL3D	M5
VEX2C	VEX2A	VEX2D	2250	34	50	242,8	73,9	79,4	63	G 1/2"	G 1/2"	74,9	27	72	110,9	92,9	36	4,3	96,9	28	5,5	7,5	-	3,0	-	4	770	VAX2C	VAX2A	VAX2D	M5

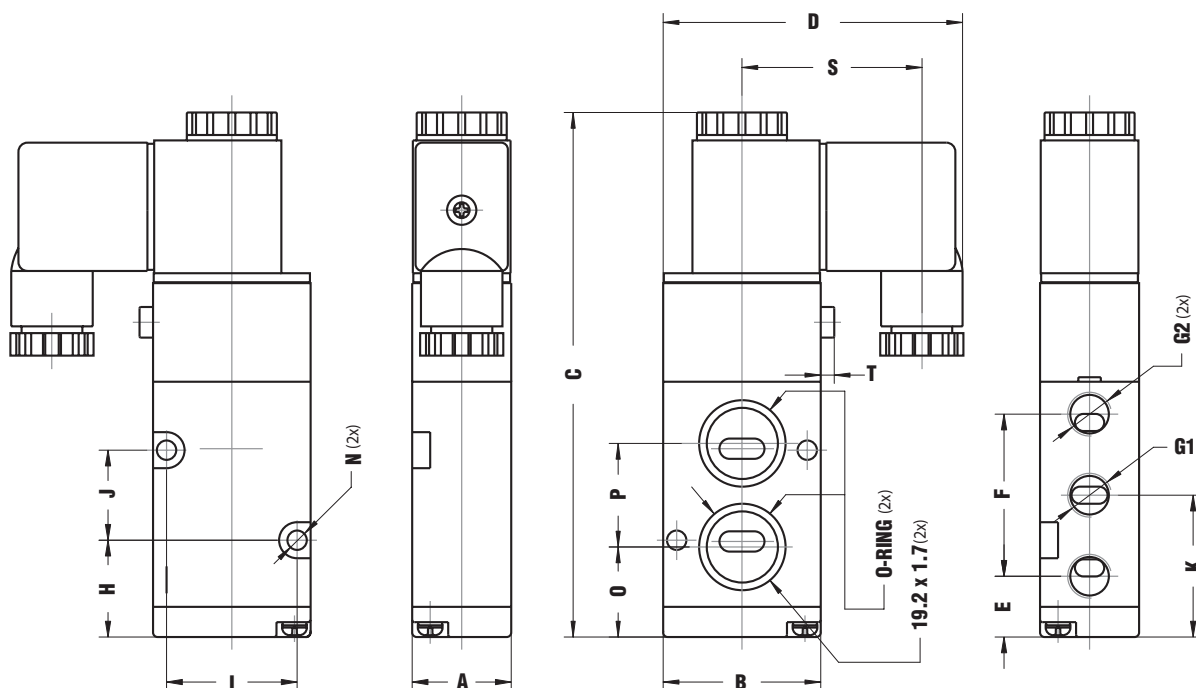

Kod	Przepływ (lt/min)	A	B	C	D	E	F	G1	G2	H	I	J	K	N	O	P	S	T	Waga (g)
VNM8M	600	22	35	116,5	66,5	13,7	36	G 1/8"	G 1/8"	21,5	29	20	31,7	4,3	20,2	23	40	3	215
VNM4M	750	22	35	116,5	66,5	13,7	36	G 1/4"	G 1/8"	21,5	29	20	31,7	4,3	20,2	23	40	3	220
VNL4M	900	27	40	134,5	69	17,5	45	G 1/4"	G 1/4"	28	32	24	40	5,2	29,3	21,5	40	2,5	320
VNL3M	1100	27	40	134,5	69	17,5	45	G 3/8"	G 1/4"	28	32	24	40	5,2	29,3	21,5	40	2,5	315



KOD

VE  
VA  
3/2

VE  
VA  
5/2

VE  
VA  
5/3

VN  
5/2

VP  
3/2

VP  
5/2

VP  
5/3

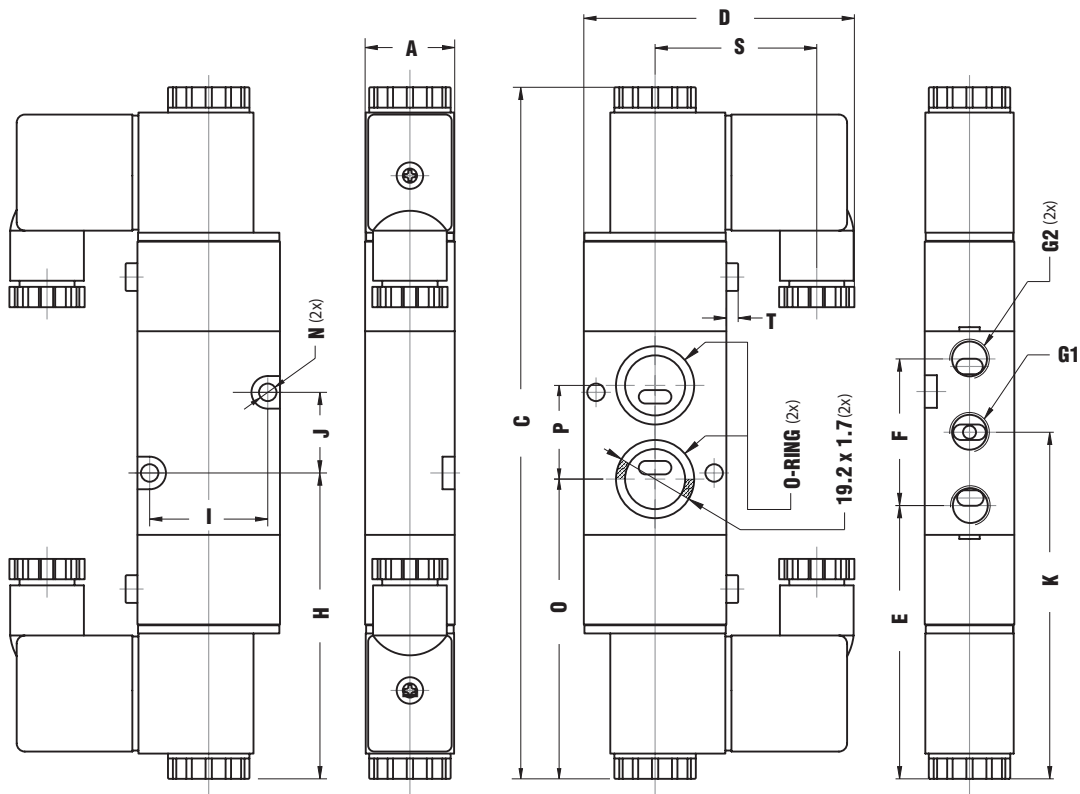
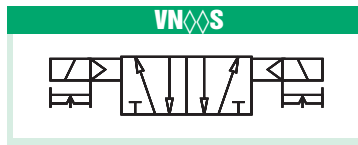
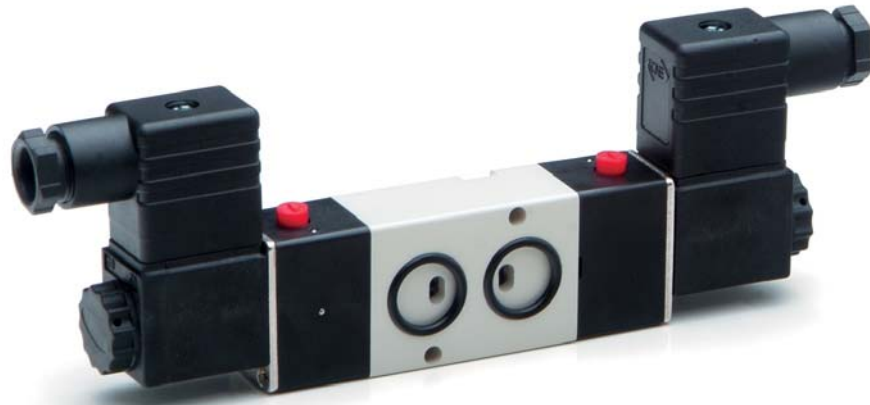

Kod	Przepływ (lt/min)	A	C	D	E	F	G1	G2	H	I	J	K	N	O	P	S	T	Waga (g)
VNM8S	600	22	169,8	66,5	67,1	36	G 1/8"	G 1/8"	75,1	29	20	85,1	4,3	73,6	23,0	40	3,0	310
VNM4S	750	22	169,8	66,5	67,1	36	G 1/4"	G 1/8"	75,1	29	20	85,1	4,3	73,6	23,0	40	3,0	310
VNL4S	900	27	188,5	69,0	71,9	45	G 1/4"	G 1/4"	82,0	32	24	94,4	5,2	83,3	21,5	40	2,5	405
VNL3S	1100	27	188,5	69,0	71,9	45	G 3/8"	G 1/4"	82,0	32	24	94,4	5,2	83,3	21,5	40	2,5	400

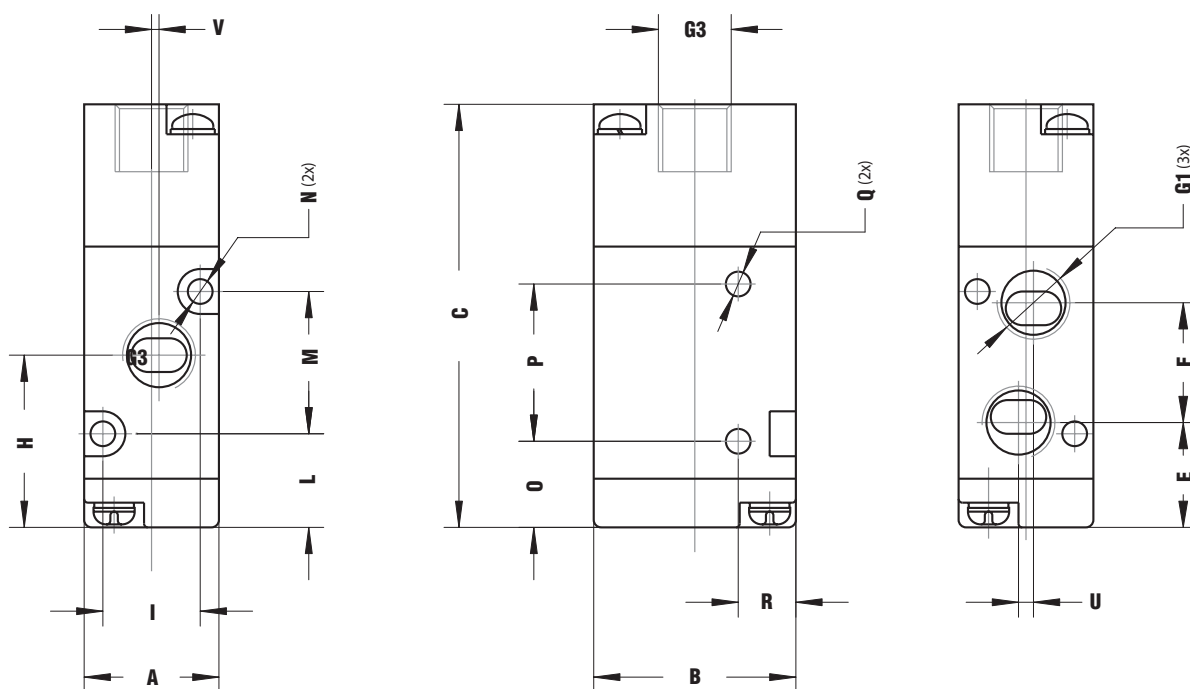
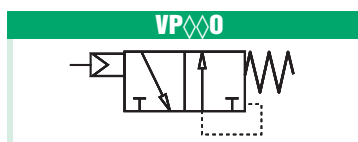
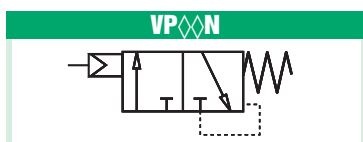

Kod		Przepływ (lt/min)	A	B	C	E	F	G1	G3	H	I	L	M	N	O	P	Q	R	U	V	Waga (g)
VPS80	VPS8N	450	18	27	56,5	14	16	G 1/8"	G 1/8"	23	13	12,5	19	3,3	11,5	21	3,3	7,7	2	1	70
VPM80	VPM8N	750	22	35	70	16	22,5	G 1/8"	G 1/8"	29	17	12,5	30	3,2	15	25	4,3	8	-	-	130
VPM40	VPM4N	750	22	35	70	16	22,5	G 1/4"	G 1/8"	29	17	12,5	30	3,2	15	25	4,3	8	-	1,5	125
VPL40	VPL4N	1100	27	40	80,5	20,5	24	G 1/4"	G 1/8"	32,5	20	15	35	4,3	17,5	30	4,3	10,5	-	-	210
VPL30	VPL3N	1100	27	40	80,5	20,5	24	G 3/8"	G 1/8"	32,5	20	15	35	4,3	17,5	30	4,3	10,5	-	2	205

KOD

VE  
VA  
3/2

VE  
VA  
5/2

VE  
VA  
5/3

VN  
5/2

VP  
3/2

VP  
5/2

VP  
5/3

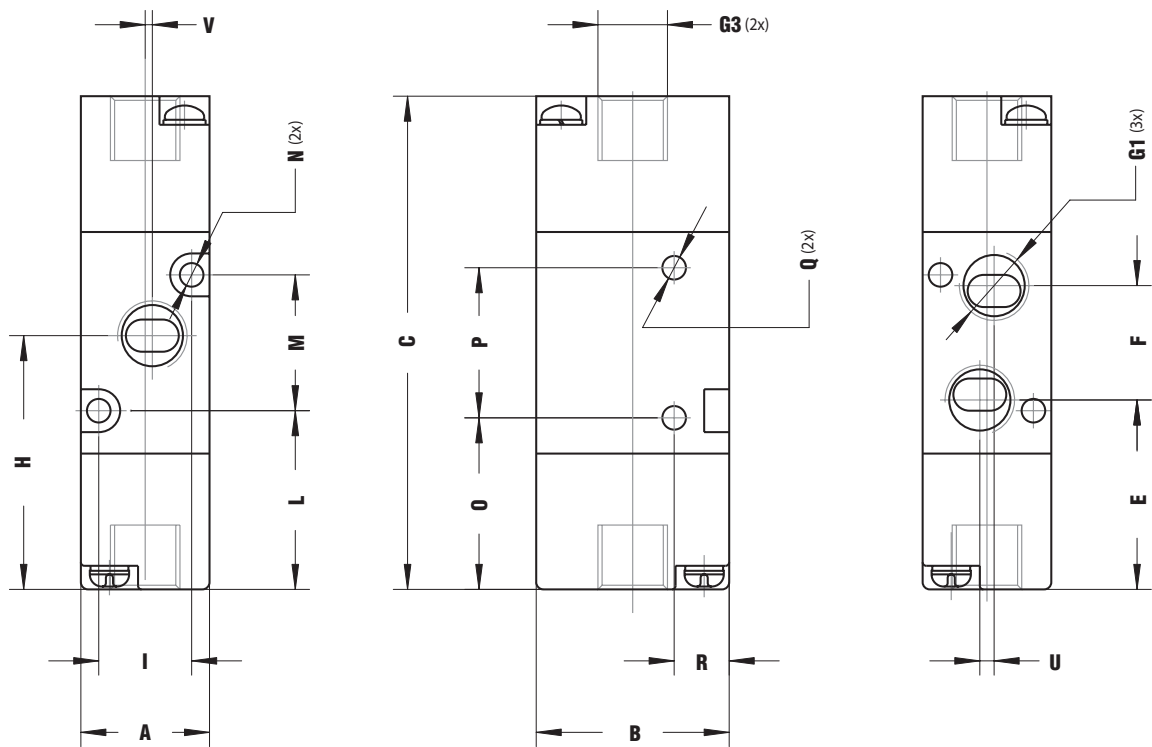
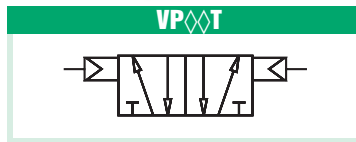

Kod	Przepływ (lt/min)	A	B	C	E	F	G1	G3	H	I	L	M	N	O	P	Q	R	U	V	Waga (g)
VPS8T	450	18	27	69	26,5	16,0	G 1/8"	G 1/8"	35,5	13	25,0	19	3,3	24,0	21	3,3	7,7	2	1	75
VPM8T	750	22	35	84	30,5	22,5	G 1/8"	G 1/8"	42,0	17	26,0	30	3,2	29,5	25	4,3	8,0	-	-	145
VPM4T	750	22	35	84	30,5	22,5	G 1/4"	G 1/8"	43,0	17	27,0	30	3,2	29,5	25	4,3	8,0	-	1,5	140
VPL4T	1100	27	40	96	36,0	24,0	G 1/4"	G 1/8"	48,0	20	30,5	35	4,3	33,0	30	4,3	10,5	-	-	230
VPL3T	1100	27	40	96	36,0	24,0	G 3/8"	G 1/8"	48,0	20	30,5	35	4,3	33,0	30	4,3	10,5	-	-	225

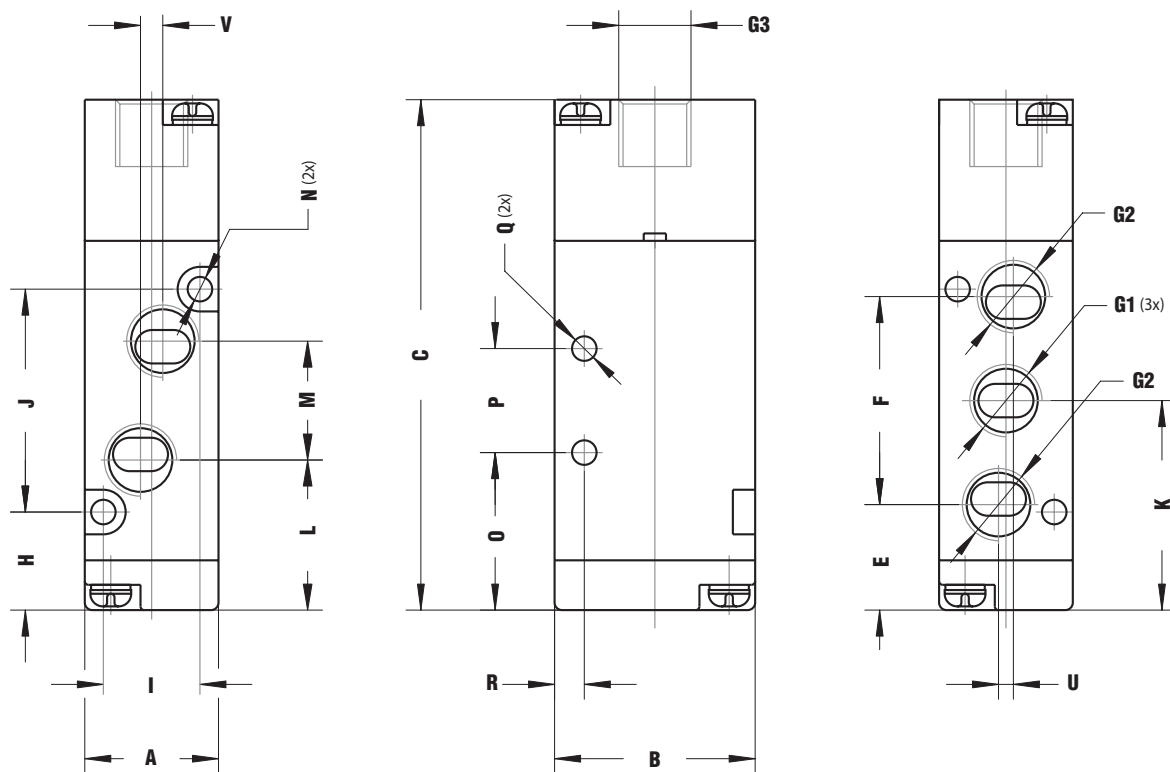
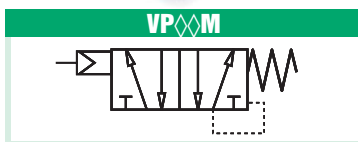

Kod	Przepływ (lt/min)	Dimensions																			Waga (g)		
		A	B	C	E	F	G1	G2	G3	H	I	J	K	L	M	N	O	P	Q	R		U	V
VPS8M	500	18	27	68,7	14,2	28	G 1/8"	G 1/8"	G 1/8"	13,2	13	30	28,2	20,2	16	3,3	21,2	14	3,3	4,0	2	-	120
VPM8M	600	22	35	77,7	13,7	36	G 1/8"	G 1/8"	G 1/8"	12,7	17	38	31,7	22,7	18	3,2	21,7	20	4,3	7,0	-	-	220
VPM4M	750	22	35	77,7	13,7	36	G 1/8"	G 1/4"	G 1/8"	12,7	17	38	31,7	21,2	21	3,2	21,7	20	4,3	7,0	-	3	220
VPL4M	900	27	40	95,5	17,5	45	G 1/4"	G 1/4"	G 1/8"	15,0	20	50	40,0	29,0	22	4,3	28,0	24	4,3	6,5	-	-	310
VPL3M	1100	27	40	95,5	17,5	45	G 3/8"	G 1/4"	G 1/8"	15,0	20	50	40,0	28,0	24	4,3	28,0	24	4,3	6,5	-	4	310
VPX2M	2250	34	50	167,9	25,5	63	G 1/2"	G 1/2"	G 1/8"	21,0	27	72	57,0	39,0	36	4,3	43,0	28	5,5	7,5	-	4	590

KOD

VE  
VA  
3/2

VE  
VA  
5/2

VE  
VA  
5/3

VN  
5/2

VP  
3/2

VP  
5/2

VP  
5/3

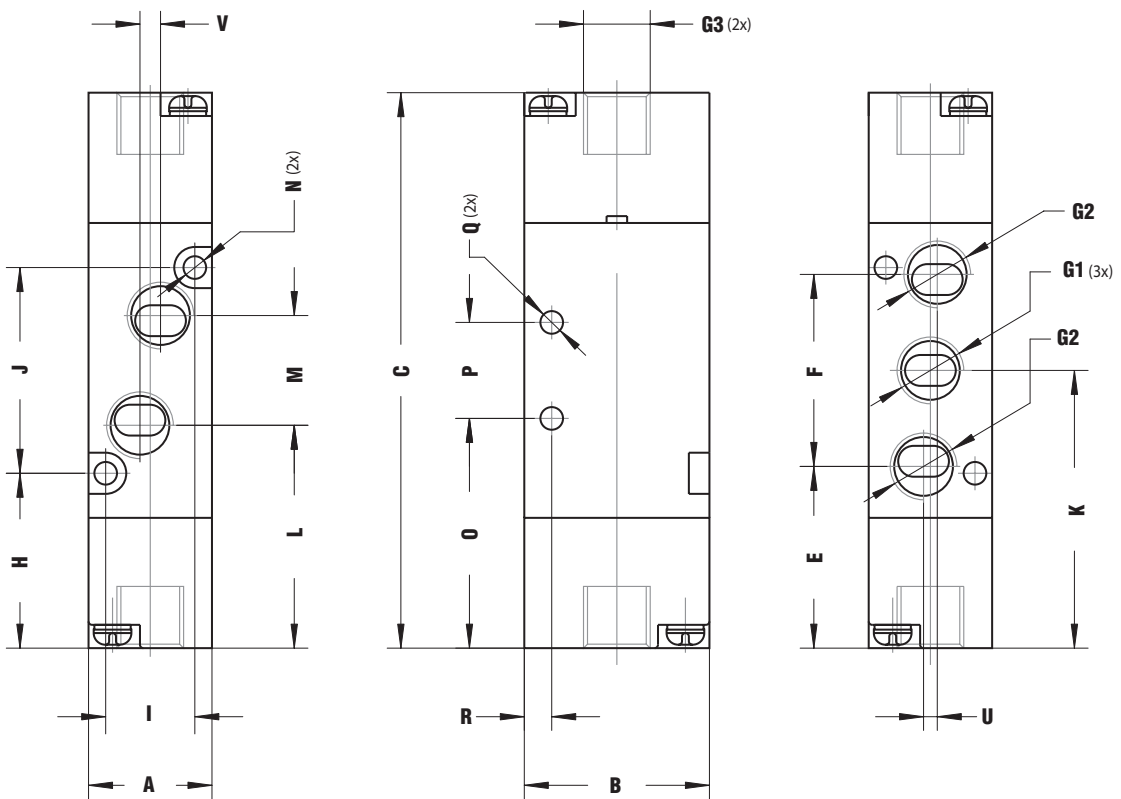
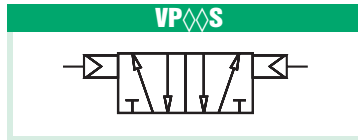

Kod	Przepływ (lt/min)	A	B	C	E	F	G1	G2	G3	H	I	J	K	L	M	N	O	P	Q	R	U	V	Waga (g)
VPS8S	500	18	27	81	26,5	28	G 1/8"	G 1/8"	G 1/8"	25,5		30	40,5	32,5	16	3,3	33,5	14	3,3	4,0	2	3	175
VPM8S	600	22	35	92	28,0	36	G 1/8"	G 1/8"	G 1/8"	27,0	17	38	46,0	37,0	18	3,2	36,0	20	4,3	7,0	-	-	320
VPM4S	750	22	35	92	28,0	36	G 1/8"	G 1/4"	G 1/8"	27,0	17	38	46,0	35,5	21	3,2	36,0	20	4,3	7,0	-	3	320
VPL4S	900	27	40	111	33,0	45	G 1/4"	G 1/4"	G 1/8"	30,5	20	50	55,5	44,5	22	4,3	43,5	24	4,3	6,5	-	-	400
VPL3S	1100	27	40	111	33,0	45	G 3/8"	G 1/4"	G 1/8"	30,5	20	50	55,5	43,5	24	4,3	43,5	24	4,3	6,5	-	4	400
VPX2S	2250	34	50	142	39,5	63	G 1/2"	G 1/2"	G 1/8"	35,0	27	72	71,0	53,0	36	4,3	57,0	28	5,5	7,5	-	4	770



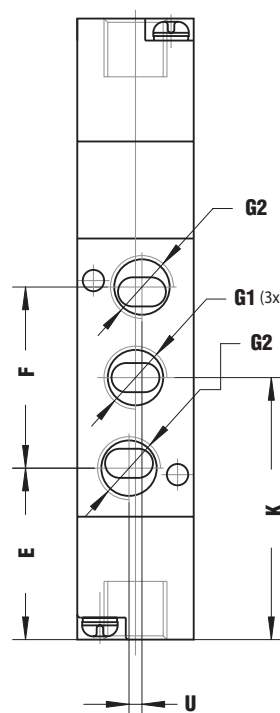
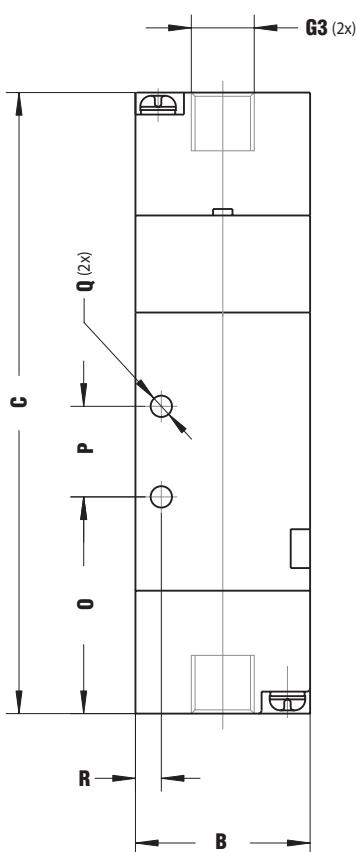
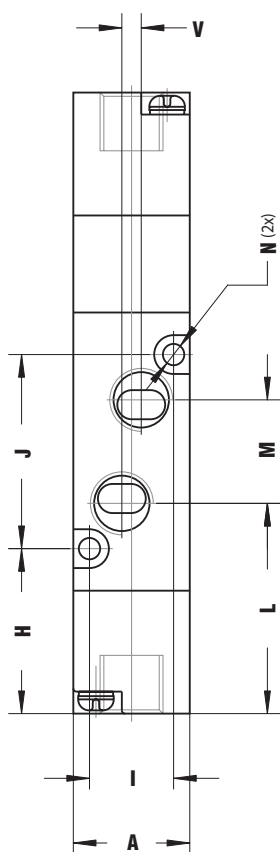
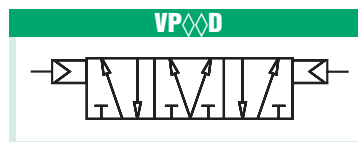
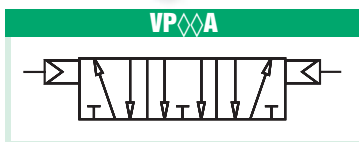
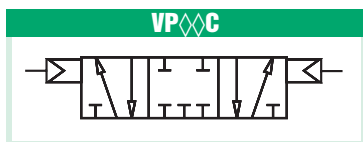

Kod			Przepływ (lt/min)	A	B	C	E	F	G1	G2	G3	H	I	J	K	L	M	N	O	P	Q	R	U	V	Waga (g)
VPS8C	VPS8A	VPS8D	500	18	27	96	26,5	28	G 1/8"	G 1/8"	G 1/8"	25,5		30	40,5	32,5	16	3,3	33,5	14	3,3	4,0	2	3	200
VPM8C	VPM8A	VPM8D	600	22	35	111	28,0	36	G 1/8"	G 1/8"	G 1/8"	27,0	17	38	46,0	37,0	18	3,2	56,0	20	4,3	7,0	-	-	400
VPM4C	VPM4A	VPM4D	750	22	35	111	28,0	36	G 1/4"	G 1/8"	G 1/8"	27,0	17	38	46,0	35,5	21	3,2	56,0	20	4,3	7,0	-	3	400
VPL4C	VPL4A	VPL4D	900	27	40	130	33,0	45	G 1/4"	G 1/4"	G 1/8"	30,5	20	50	55,5	44,5	22	4,3	43,5	24	4,3	6,5	-	-	540
VPL3C	VPL3A	VPL3D	1100	27	40	130	33,0	45	G 3/8"	G 1/4"	G 1/8"	30,5	20	50	55,5	43,5	24	4,3	43,5	24	4,3	6,5	-	4	540
VPX2C	VPX2A	VPX2D	2250	34	50	163	39,5	63	G 1/2"	G 1/2"	G 1/8"	35,0	27	72	71,0	53,0	36	4,3	57,0	28	5,5	7,5	-	4	770